



Hello Everyone

Welcome to the Cheshire Show Special of our Members Newsletter. Our competitors really do create some amazing floral designs. Congratulations to you all – so proud of you and thank you for flying the floral and Cheshire flag! However, have you ever wondered how it all comes together? This newsletter supplement shares a few snippets from behind the scenes. For all the official photos and results / prize winner please head to our website. Huge thank you to Pam Mosedale (for getting up at the crack of dawn) and for taking all the photos and to our website manager, Mike Gallagher for adding them to our site so quickly:

*The Flower Clubs of Cheshire website displays photos taken of the individual class award winners and entries in every category. You can also access individual class presentation photos and discover who are the trophy and special award winners.*

Access all of them at: [www.nafascheshire.org.uk/royal-cheshire-show-2025.htm](http://www.nafascheshire.org.uk/royal-cheshire-show-2025.htm)

In the beginning, there was the title. Planning started in June 2024! Then came the Show Schedule.

**If music be the food  
of love..... 'read' on**



**This year the Competition Schedule has a musical theme. There are 12 classes in total with opportunities for the novice competitor, a chance to enter as a team, two craft classes, semi imposed, plus classes for petite, hanging and still life exhibits.**

**Royal Cheshire Show**

**incorporating**

**CHESHIRE AREA SHOW**

**in the**

**'Theatre of Flowers'**

**TUESDAY 17th &**

**WEDNESDAY 18th JUNE 2025**

**MAKE YOUR OWN KIND  
OF MUSIC**

After many planning meetings, some sawing, painting and shopping, we were almost ready to meet our new marquee! On Tuesday 10<sup>th</sup> June we met her – 20m x 55m! Bit bigger than in the past and a different way round.

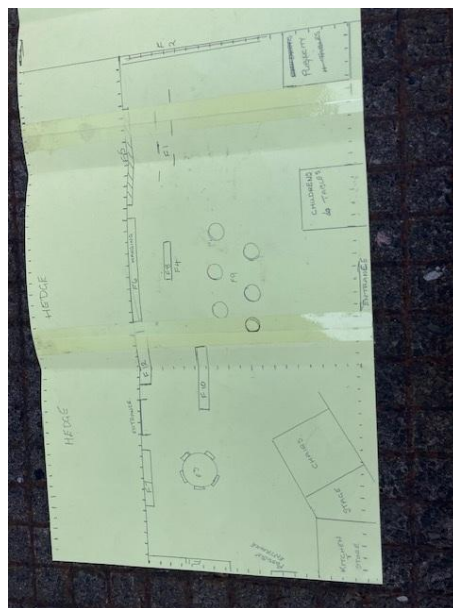

On Thursday evening, after the CAS Health and Safety briefing, out came the spray paint to mark out the areas ready for the build on Friday. This was our outline plan. Thank you to Mike Shevlin, Paul Clancy, Tony (tractor) and Richie for all your help in getting 'stuff' from the lockup to the marquee and building the 'set' for the 'Theatre of Flowers'.



It's surprising how a few tables and chairs start to fill up the space. Then the master class in table levelling, drapes levelling, rucking and space measuring begins.



The first build of the publicity area 'Wicked' by Stockport & Romiley Flower Clubs commenced on Friday – full creation and build with flowers planned for Sunday 15<sup>th</sup> June.



Saturday (very early) is flower delivery day from the wholesalers for all the flowers for the President's Marquee table flowers, buttonholes for the CAS dignitaries, for Children's Hands on and marquee entrance. A master class in conditioning!



Members of the Show Team Jenny Williams, Ruth Cattrell, Carol Baker and Maureen Hernon make a start on the table vases for the President's Marquee, and Ruth prepares for Children's Hands On.



Entrance floral design created by Sylvia Bower



Eleanor Griffiths created the pedestals for the President's Marquee



On Sunday 15<sup>th</sup> June the Competition began and we welcomed our competitors into the marquee to create 67 stunning designs. A bare, white marquee suddenly became filled with colour and chatter. Here's a few designs in the 'work in progress' stage.....





All proficient flower arrangers know it is mechanics first.....











And then .....we were ready for Judging on Monday afternoon. Our judges this year were Jackie Charnock and Donald Morgan.





Let the Show begin.....

We welcomed over 4,000 people into the marquee, who were ‘in awe’ of the designs created. Congratulations to all our competitors and thank you for sharing your talents and love of flowers with everyone – and inspiring so many people along the way. Thanks to our demonstrators on Tuesday (Julie Pearson and Debbie Davies) and Wednesday (Eleanor Griffiths and Jane Tully) for showing our audiences ‘how it’s done’. Here’s a round-up of the finished results and some of our visitors into the ‘Theatre of Flowers’:



People’s Choice Award to the Knutsford Team



Janet S  
with our  
website  
manager  
Mike G  
being  
‘Wicked’!





Best in Show awarded to  
Eleanor Griffiths for Swan Lake